

GW1102-2D (RS-232)

2-Port RS-232 to Ethernet Modbus Gateway

Features

1. Support Modbus TCP, Modbus RTU, Modbus ASCII, IP, ARP, DHCP and DNS protocol
2. Support 1 Port 10/100M Ethernet
3. Support 2 Port RS-232
4. Support WEB and Telnet configuration
5. Convert between Modbus TCP and Modbus RTU/ASCII
6. Support RTU Slave, RTU Master, ASCII Slave, ASCII Master four operating modes
7. Support ID mapping function, to achieve the management of the host ID
8. 300bps~115200bps baud rate and nonblocking communication
9. Support IP address and MAC address filtering function
10. Slave mode support 16 TCP master connections
11. Master mode support 32 slave TCP connection requests
12. Support Response Timeout and Interval Timeout setting
13. Support cross-gateway and cross-router communication
14. IP30 protection grade, metal shell, wall mounted installation
15. No fan, low consumption design
16. Working temperature: -40~75 °C



Introduction

GW1102-2D (RS-232) is an industrial Ethernet Modbus gateway that converts between Modbus TCP and Modbus RTU/ASCII protocols. It provides 2 port RS-232 serial (RJ45) and 1 port 10/100M Ethernet.

Modbus TCP, Modbus RTU and Modbus ASCII protocol are integrated in the products, users can easily realize the seamless integration of Modbus Ethernet devices and Modbus serial devices

and even multi master and slave hybrid networks. At the same time, the user can be set up by Web or Telnet. The simple design can not only realize the fast application, but also guarantee the application of the entire real industrial environment.

The products using EMC protection design, can work in rugged environment.

Dimension

Unit (mm)

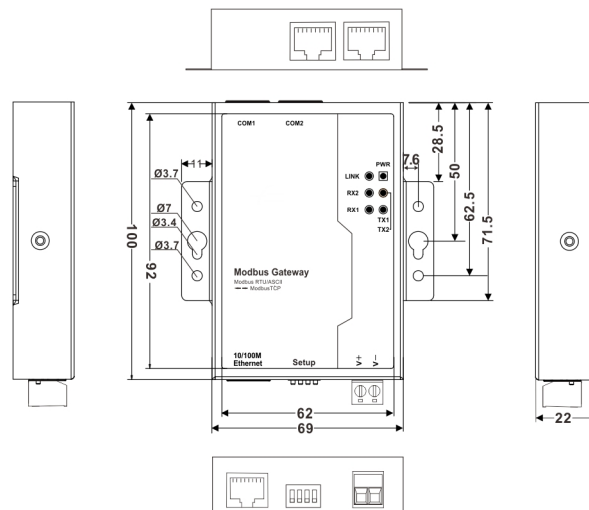



Specification

Ethernet port

Standard: 10Base-T, 100Base-TX

Protocol: Support Modbus TCP, Modbus RTU, Modbus ASCII, IP, APR, ICMP, DNS and DHCP

Signal: Rx+, Rx-, Tx+, Tx-

Speed: 10/100Mbps

Working: Full-duplex and half duplex

Transfer distance: 100m

Connector: RJ45

Serial port

Serial port number: 2 ports RS-232

RS-232 signal: TXD, RXD, RTS, CTS, GND

Parity bit: None, Even, Odd, Space, Mark

Data bit: 7bit, 8bit

Stop bit: 1bit, 2bit

Baud rate: 300bps~115200bps

RS-232 transfer distance: 15m

RS-232 connector: RJ45

Protection: class 3 static

Master mode: 32 TCP slaves

Slave mode: 16 TCP masters

Work mode: RTU Slave, RTU Master, ASCII Slave, and ASCII Master

LED Indicator

Power (PWR)

Ethernet port connect status (Link)

Serial port data indicator: TX1~TX2, RX1~RX2;

Power requirements

Input voltage: 9~48VDC

No-load consumption: 0.79W@9V

Full-load consumption: 0.86W@9V

Environment limits

Working temperature: -40~75°C

Storage temperature: -40~85°C

Relative humidity: 5%~95% (non-condensing)

Mechanical

Shell: IP30 protection, metal shell

Installation: Wall mounting

Weight: 230g

Size (L×W×H): 100mm×69mm×22mm

Standard

EMI: EN 55022 Class A, FCC Part 15 Subpart B Class A

EMS: EN 61000-4-2 (ESD), Level 3

Shock: IEC 60068-2-27

Free fall: IEC 60068-2-32

Vibration: IEC 60068-2-6

Warranty

Warranty time: 3 years

Certificates

CE, FCC, RoHS, UL508 (pending)

Ordering Information

GW1102-2D(RS-232)-P (9~48VDC): 2-port RS-232 to Ethernet Modbus Gateway (10M/100M), DC9~48V, wall mounting

Packing List

1. GW1102-2D(RS-232)-P(9~48VDC) × 1
2. User manual × 1
3. Straight network cable × 1
4. Power adapter × 1
5. CD × 1
6. Warranty card × 1
7. Certificate of quality × 1

Optional accessories:

DIN-Rail Mounting Kit (35mm) × 1